

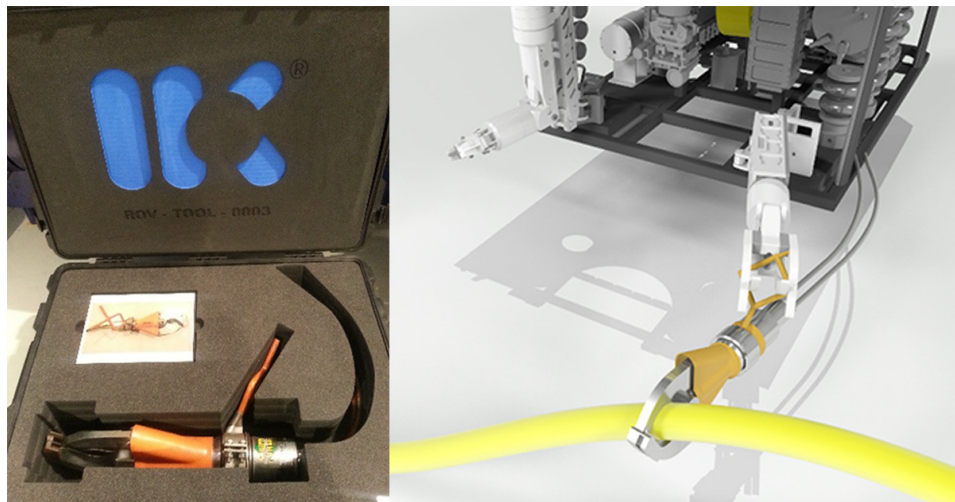

## ROV Cable Cutter



### Introduction

IK's ROV operated Hydraulic Cable Cutter (HCC) is an easy tool to install and operate by ROV, works like a scissor, with two blades with guides for extra strength and durability. The unit is supplied complete with hoses and manipulator handle ready for installation to the host ROV

## ROV Cable Cutter

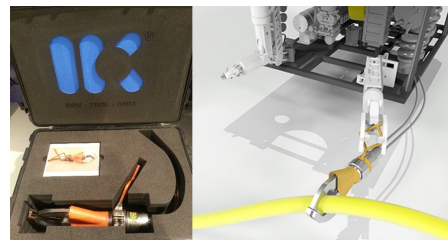

### Product specification

#### Technical specification

- Tool Dimensions (LxWxH): 692 x 361 x 312 mm (27,2x14,2x12,3 in)
- Max cutting opening: 134 mm (5,3 in)
- Maximum Working Pressure: 500/50 (bar/Mpa) - (7252 psi)
- Maximum Cutting Force: 242/24,7 ( kN/t) - (54404 lbf)
- Required oil content (effective): 84 cc (2,8 oz)
- Temperature range: -20 to +80 °C (-4 +176 °F)
- Pressure Open connection: Faster PVVM 1/14-NPT-F
- Pressure Close connection: Faster PVVM 1/14-NPT-F
- Tool dry weight: 28,5 Kg (62,8 lb)
- Blade Type: 10 Cable
- Tool operation: Hydraulic
- Model: ICU20S10V – Blade Cable

### Contact for this product is:

**Kenneth Olaf Rosén:** Pipe Intervention & AOGV Manager - IK Norway  
T: +47 992 79 828

